

Atlantic Room Floor Plan

The Atlantic Room is entirely private and features a dedicated kitchen and wait staff and an Audio Visual Package including a 65" flat-screen TV, wireless lavalier or handheld microphone, and HDMI inputs for an additional fee.

We can arrange each of our private dining rooms to create precisely the feel you desire, for business meetings, rehearsal dinners and more.

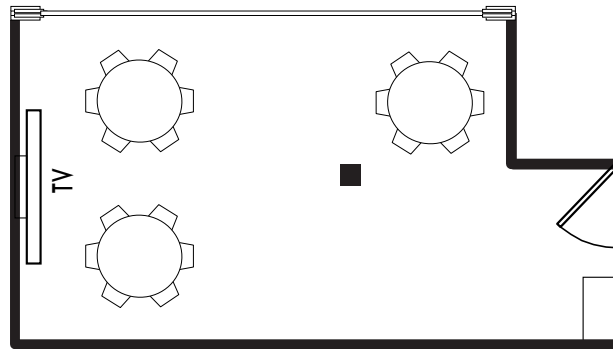

The Atlantic Room is 16'10" x 20'1"

- 24 Seated with Full Rounds
- 18 Seated with Crescent Rounds
- 12 Seated Boardroom Style
- 30 Cocktail Style Reception

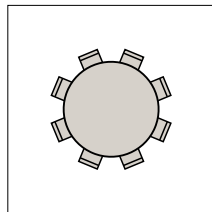

ROUND
(8 Seats/Table)
Seats up to
24 guests

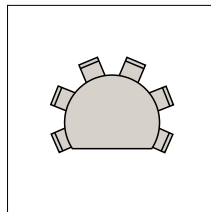

CRESCENT
(6 Seats/Table)
Seats up to
18 guests

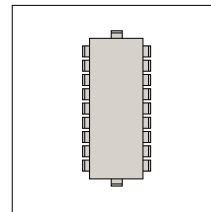

BOARDROOM
Seats up to
12 guests